

Free Project
NOT FOR RESALE

ENDLESS FUN



Featuring fabrics from the **Snow Angels** collection by Rob Parkinson for **STUDIO C Fabrics**

Fabric Requirements

(A) 7739-11	¼ yard
(B) 7733-01	⅓ yard
(C) 7734-69	⅓ yard
(D) 7735-66	⅓ yard
(E) 7736-06	⅓ yard
(F) 7738-07	⅓ yard
(G) 7737-11	⅝ yard
(H) 7739-88	¾ yard ⁺⁺
(I) 7732-11	1 yard

(J) White Sugar-9*	1 yard
Backing 7730-86	3½ yards

⁺⁺Includes binding.
*Peppered Cottons Collection.

Please check our website for pattern updates before starting this project.

Additional Supplies Needed

Batting: 59" x 73"
(Recommended: Air Lite® Colour Me 100% Cotton)
Sewing and Quilting thread
Sewing and Quilting supplies

Quilt size: 51" x 64½"
Skill Level: Beginner
Quilt designed by Denise Russell.

Fabrics in the Collection



7740-81 9.35" Blocks - Red



7731-71 Border Stripe - Blue



7730-86 Patchwork
Red

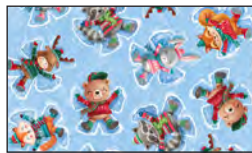

7732-11 Tossed Snow
Angels - Lt. Blue

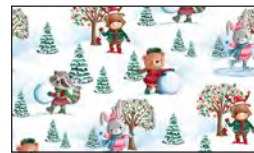

7733-01 Winter
Animal Scenic - White



7734-69 Animal Crowd
Multi



7735-66 Tossed Wreaths
with Animals - Green



7736-06 Christmas Tree
Allover - White



7737-11 Tossed Hats
and Mittens - Lt. Blue

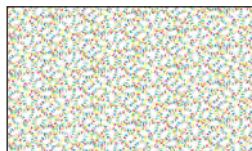

7738-07 Christmas
Light Allover - White



7739-11 Tossed
Snowflakes - Lt. Blue



7739-88 Tossed
Snowflakes - Red

Selected fabric from the
Peppered Cottons collection

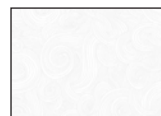

White Sugar-9

Cutting and Sewing

Cutting Instructions

Please note: All strips are cut across the width of the fabric (WOF) from selvage to selvage unless otherwise noted. (WOF = Width of Fabric, LOF = Length of Fabric).

Fabric A (7739-11 Tossed Snowflakes – Lt. Blue), cut:

*(1) 5" x WOF strip. Sub-cut (4) 5" squares.

Fabric B (7733-01 Winter Animal Scenic - White), cut:

*(2) 4½" x WOF strips. Sub-cut (12) 4½" squares.

Fabric C (7734-69 Animal Crowd – Multi), cut:

*(1) 4½" x WOF strip. Sub-cut (8) 4½" squares.

*(1) 5" x WOF strip. Sub-cut (4) 5" squares.

From each, cut:

Fabric D (7735-66 Tossed Wreaths with Animals - Green)

Fabric E (7736-06 Christmas Tree Allover - White)

*(2) 4½" x WOF strips. Sub-cut (16) 4½" squares.

Fabric F (7738-07 Christmas Light Allover - White), cut:

*(5) 1½" x WOF strips for border 2.

Fabric G (7737-11 Tossed Hats and Mittens – Lt. Blue), cut:

*(2) 4½" x WOF strips. Sub-cut (16) 4½" squares.

*(6) 1½" x WOF strips for border 4.

Fabric H (7739-88 Tossed Snowflakes - Red), cut:

*(2) 4½" x WOF strips. Sub-cut (16) 4½" squares.

*(6) 2½" x WOF strips for binding.

Fabric I (7732-11 Tossed Snow Angels – Lt. Blue), cut:

*(2) 4½" x WOF strips. Sub-cut (16) 4½" squares.

*(6) 3½" x WOF strips for border 3.

Fabric J (Peppered Cottons – White Sugar-9), cut:

*(13) 2" x WOF strips. Sub-cut:

- (144) 2" squares.

- (8) 2" x 12½" sashing strips.

- Set aside 3 strips for the horizontal sashing.

*(5) 1½" x WOF strips for border 1.

Block Assembly

1. Draw a diagonal line from corner to corner on the wrong side of (144) 2" Fabric J squares. With right sides together, place one marked Fabric J square on a corner of one 4½" Fabric I square and stitch on the drawn line. Repeat with the adjacent corner of the same square. Trim seam allowances to ¼" and press open. Make (8) 4½" units. Similarly, sew a 2" Fabric J square to only one corner of the remaining Fabric I squares to make (8) 4½" corner units (*figure 1*, next page). Set aside the remaining J squares for Steps 3-5.



Figure 1

2. Gather (2) 4½" Fabric B squares and all the Step 1 units. Arrange the units in 3 rows of 3, noting fabric orientation. Sew the units in each row together, press the seams in opposite directions, then sew the rows to make (2) 12½" blocks (figure 2). Press the seams in one direction.

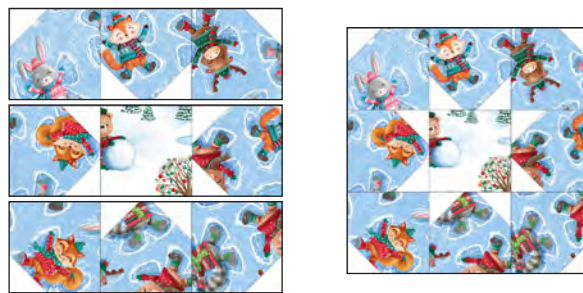

Figure 2 – Make (2) 12½" blocks.

3. Repeat Steps 1 and 2 with the marked 2" Fabric J squares and the 4½" Fabrics D, E*, G, and H squares to make (2) 12½" blocks of each type (figure 3).

***Note:** Fabric E is directional. Plan the direction of the trees on the final blocks before you sew the Fabric J squares to the corners.

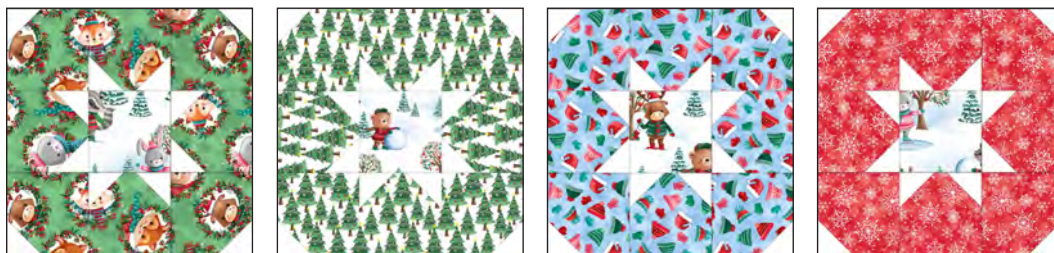

Figure 3 – Make (2) 12½" blocks of each type.

4. Draw a diagonal line from corner to corner on the wrong side of the 5" Fabric A squares. With right sides together, layer the marked Fabric A squares atop the 5" Fabric C* squares. Stitch ¼" from each side of the diagonal line, cut on the drawn line, press each unit open with the seams toward the darker fabric, and trim dog ears. Make (8) 4½" half-square triangles (HST). Trim if necessary. Sew one 2" Fabric J square to the blue corner of each unit, trim, and press as before (figure 4).

***Note:** Fabric C is directional. Plan the direction of the faces on the final blocks before you sew the Fabric J squares to the corners.

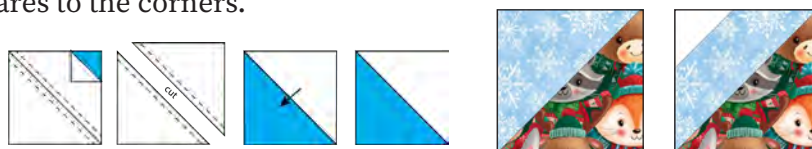

Figure 4 – Make (8) 4½" units.

Sewing

5. Place a marked 2" Fabric J square on a corner of one 4½" Fabric C square and stitch on the drawn line. Repeat with the adjacent corner of the same square. Trim seam allowances to ¼" and press open (*figure 5*). Make (8) 4½" units.

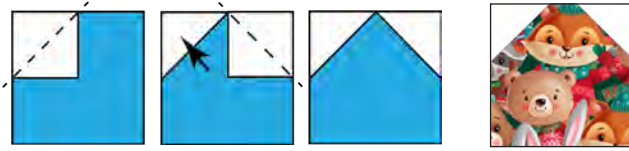

Figure 5 – Make (8) 4½" units.

6. Gather (2) 4½" Fabric B squares and all the Step 4 and 5 units. Arrange the units in 3 rows of 3, noting fabric orientation. Sew the units in each row together, press the seams in opposite directions, then sew the rows to make (2) 12½" blocks (*figure 6*). Press the seams in one direction.



Figure 6 – Make (2) 12½" blocks.

Quilt Top Assembly

(Follow the quilt diagram and photograph while assembling the quilt top.)

7. Referring to the quilt photo for block placement, lay out 3 blocks and (2) 2" x 12½" Fabric J sashing strips in 4 rows, and join the blocks and sashing strips together in each row. Press the seams toward the sashing.
8. Measure the block rows and trim the (3) 2" x WOF Fabric J strips to that length to prepare the horizontal sashing rows. Alternate the block rows and the sashing rows, then sew them together. Press the seams in one direction.
9. For border 1, sew the (5) 1½" Fabric J strips together end to end using diagonal seams. Measure the vertical length of the quilt top through the center and cut two border strips that length. Sew one strip to each side of the quilt top. Measure the width of the quilt top through the center. Cut two border strips that length and sew one to the top and one to the bottom. Press the seams toward the borders.
10. Repeat Step 9 with the (5) 1½" Fabric F strips to make and add border 2.
11. Repeat Step 9 with the (6) 3½" Fabric I strips to make and add border 3.
12. Repeat Step 9 with the (6) 1½" Fabric G strips to make and add border 4.

Sewing

Layering, Quilting, and Finishing

13. Create a quilt sandwich with the batting between the quilt top and the backing. Pin or baste layers together, mark the quilting design, and quilt by hand or machine. When the quilting is complete, remove pins or basting and trim the batting and backing even with the raw edges of the quilt top.

Binding

14. Join the (6) 2½" Fabric H binding strips together end to end using a diagonal seam to make one long strip. Fold in half lengthwise with wrong sides facing, and press. Sew binding to the edges of the quilt top, mitering corners, and overlapping ends. Fold the binding to the back of the quilt and stitch it in place by hand to finish.

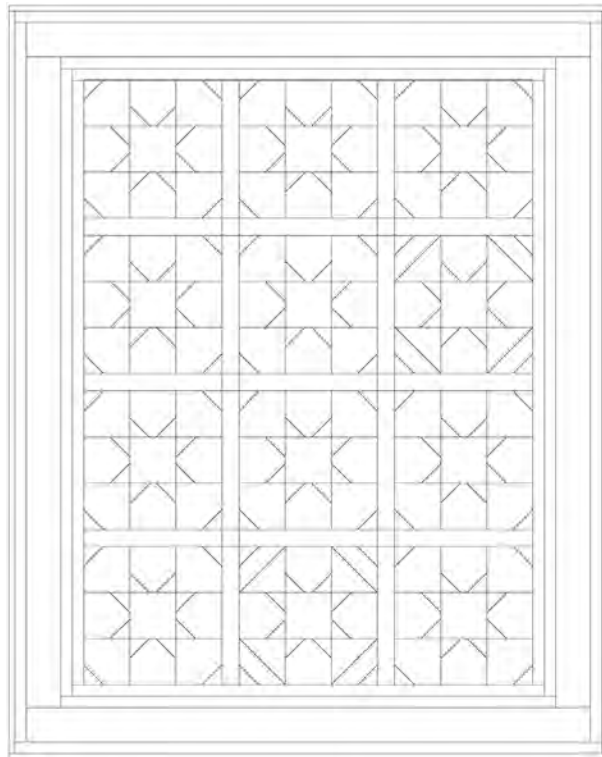

Quilt Diagram

©2023 Studio e Fabrics®

Every effort has been made to ensure that all projects are error free. All the information is presented in good faith; however, no warranty can be given nor results guaranteed as we have no control over the execution of instructions. Therefore, we assume no responsibility for the use of this information or damages that may occur as a result. When errors are brought to our attention, we make every effort to correct and post a revision as soon as possible. Please make sure to check www.studioefabrics.net for pattern updates prior to starting the project. We also recommend that you test the project prior to cutting for kits. Finally, all free projects are intended to remain free to you and are not for resale.