



Table Runner & Placemats



Featuring the
Cottontail Farm Collection
by Caverly Smith
Shipping to stores January 2024



Finished Table Runner Size: 44 ½ in x 24 ½ in (113.03 cm x 62.23 cm)
Finished Placemat Size: 12½ in x 16 ½ in (31.75 cm x 41.91 cm) each – Makes 4

Fabric Needed

3 Wishes Fabric® Cottontail Farm Collection

Table Runner

- ¾ yd – Tossed Flowers (21541-TEA-CTN-D) for Piecing and Binding
- ⅝ yd – Chickens on a Wire (21540-BLU-CTN-D)
- ½ yd – Farm Day (21538-WHT-CTN-D)
- ⅓ yd – Cottontail Toss (21539-GRN-CTN-D)
- ¼ yd – Duck Duck Goose (21542-YLW-CTN-D)
- 1 ½ yds – Chicken on a Wire (21540-BLU-CTN-D) for Backing

Not included in the 3 Wishes Fabric® Cottontail Farm Collection

- ¼ yd – Solid Off-White Cotton

Placemats

- ⅞ yd – Tossed Flowers (21541-TEA-CTN-D) for Piecing and Binding
- ⅓ yd – Farm Day (21538-WHT-CTN-D)
- ⅓ yd – Chickens on a Wire (21540-BLU-CTN-D)
- 1 yd – Tossed Flowers (21541-TEA-CTN-D) for Backing

Not included in the 3 Wishes Fabric® Cottontail Farm Collection

- ⅓ yd – Solid Off-White Cotton

Additional Supplies Needed:

Table Runner

- 1 – 32 in x 52 in (81.26 cm x 132.08 cm) Cotton batting

Placemats

- 4 – 16 in x 20 in (40.64 cm x 50.8 cm) Cotton batting

- Piecing and sewing thread
- Quilting and sewing supplies
- Even-feed foot (optional for quilting)

Before You Begin

Read all instructions before beginning project. Do not pre-wash fabrics. Press fabrics with a dry iron on cotton setting before cutting. Use a ¼ in (6.35 mm) seam allowance and sew fabrics with right sides together (RST) unless otherwise noted. Press seams in the direction of the arrows. wof = width of fabric

Cutting

Use a rotary cutter and ruler to cut the size and number of squares and rectangles from each fabric listed below.

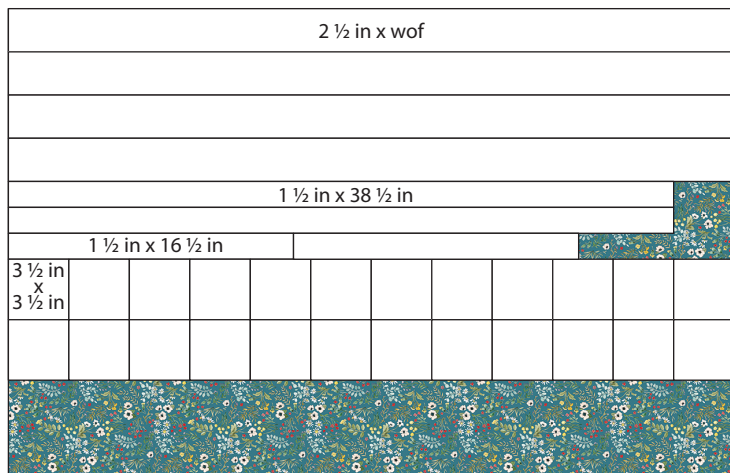

Tossed Flowers (21541-TEA-CTN-D) – ¾ yd (68.58 cm x 106.68 cm)

Cut 4 – 2 ½ in x wof (6.35 cm x 106.68 cm) for Binding

Cut 2 – 1 ½ in x 38 ½ in (3.81 cm x 97.79 cm)

Cut 2 – 1 ½ in x 16 ½ in (3.81 cm x 41.91 cm)

Cut 24 – 3 ½ in x 3 ½ in (8.89 cm x 8.89 cm)

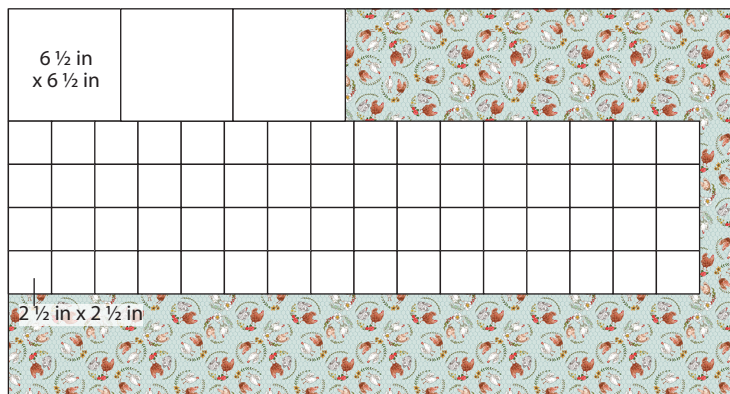

Chickens on a Wire (21540-BLU-CTN-D) – ¾ yd (57.15 cm x 106.68 cm)

Cut 3 – 6 ½ in x 6 ½ in (16.51 cm x 16.51 cm)

Cut 64 – 2 ½ in x 2 ½ in (6.35 cm x 6.35 cm)

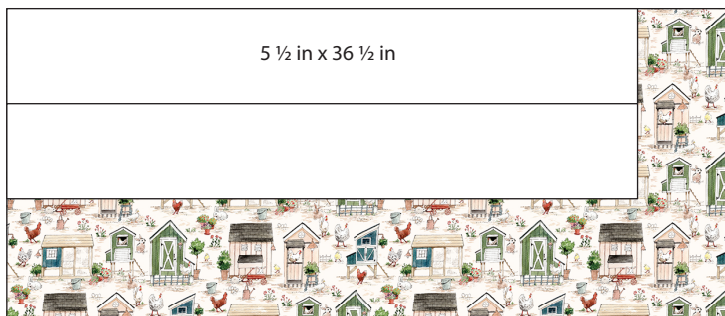

Farm Day (21538-WHT-CTN-D) – ½ yd (45.72 cm x 106.68 cm)

Cut 2 – 5 ½ in x 36 ½ in (13.97 cm x 92.71 cm)



Cottontail Toss (21539-GRN-CTN-D) – ½ yd (30.48 cm x 106.68 cm)

Cut 30 – 2 ½ in x 4 ½ in (6.35 cm x 11.43 cm)



Duck Duck Goose (21542-YLW-CTN-D) – ¼ yd (22.86 cm x 106.68 cm)

Cut 2 – 6 ½ in x 6 ½ in (16.51 cm x 16.51 cm)

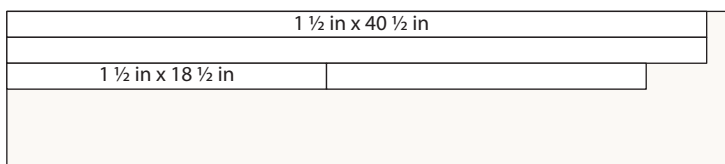

Solid Off-White – ¼ yd (22.86 cm x 106.68 cm)

Cut 2 – 1 ½ in x 40 ½ in (3.81 cm x 102.87 cm)

Cut 2 – 1 ½ in x 18 ½ in (3.81 cm x 46.99 cm)

Tossed Flowers (21541-TEA-CTN-D) – 7/8 yd (80.01 cm x 106.68 cm)
 Cut 7 – 2 1/2 in x wof (6.35 cm x 106.68 cm) for Binding
 Cut 8 – 1 1/2 in x 12 1/2 in (3.81 cm x 31.75 cm)
 Cut 8 – 1 1/2 in x 10 1/2 in (3.81 cm x 26.67 cm)

Chickens on a Wire (21540-BLU-CTN-D) – ⅓ yd (30.48 cm x 106.68 cm)
Cut 30 – 2 ½ in x 4 ½ in (6.35 cm x 11.43 cm)

Farm Day (21538-WHT-CTN-D) – ⅓ yd (30.48 cm x 106.68 cm)
Cut 4 – 10 ½ in x 10 ½ in (26.67 cm x 26.67 cm)

Solid Off-White – ⅓ yd (30.48 cm x 106.68 cm)
Cut 48 – 2 ½ in x 2 ½ in (6.35 cm x 6.35 cm)

5. Place three Unit 1 squares and three Unit 2 squares as shown in Diagram C. Pin RST, sew and press to make Unit 3 which should measure 6 ½ in x 36 ½ in (16.51 cm x 92.71 cm).

Dia. C

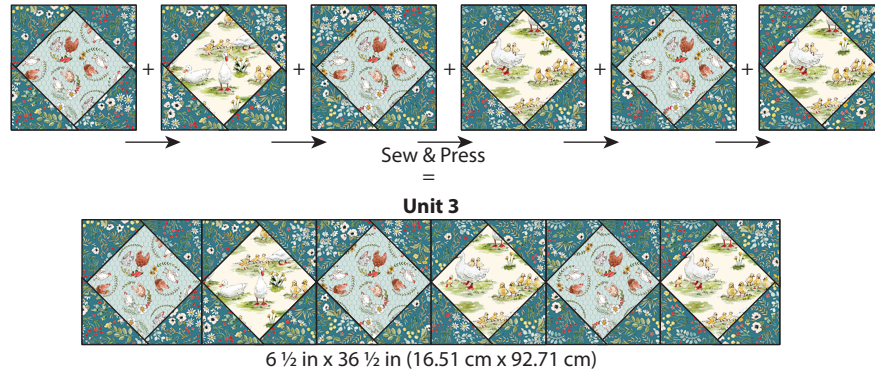

6. Refer to Diagram D to sew one Farm Day strip 5 ½ in x 36 ½ in (13.97 cm x 92.71 cm) to the top and bottom of the Unit 3 to make the Table Runner Center. The Table Runner Center should measure 16 ½ in x 36 ½ in (41.91 cm x 92.71 cm).

Dia. D

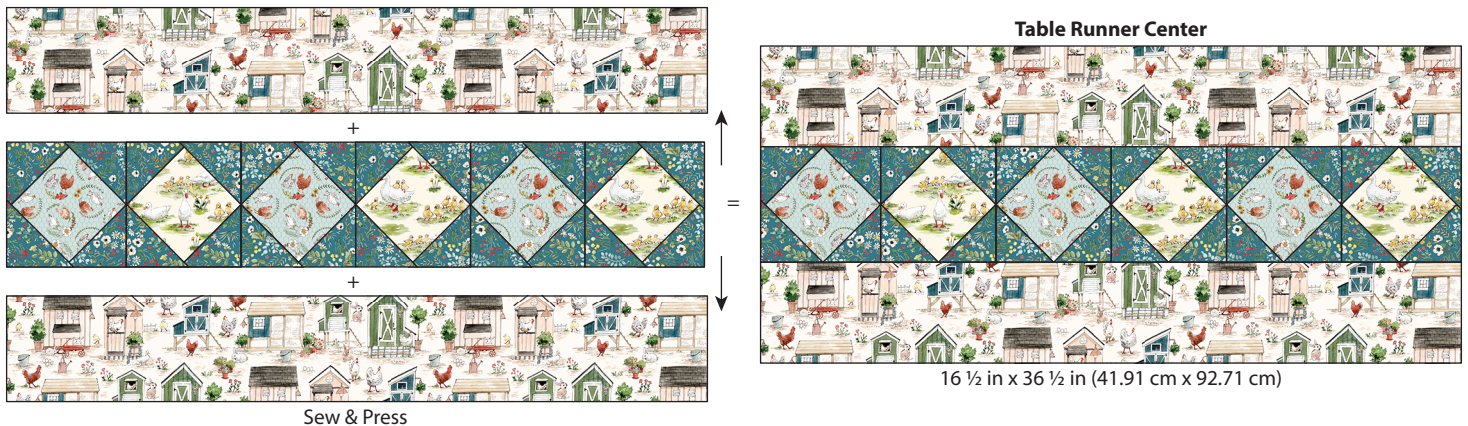

7. Place one Chickens on a Wire square 2 ½ in x 2 ½ in (6.35 cm x 6.35 cm) on the left side of one Cottontail Toss strip 2 ½ in x 4 ½ in (6.35 cm x 11.43 cm) RST. Sew across the diagonal of the square from the upper right corner to the lower left corner as shown in Diagram E. Flip open the triangle formed and press. Trim seam allowance to ¼ in (6.35 mm).
8. Place one Chickens on a Wire square 2 ½ in x 2 ½ in (6.35 cm x 6.35 cm) on the right side of one Cottontail Toss strip RST. Sew across the diagonal of the square from the upper left corner to the lower right corner as shown in Diagram E. Trim seam allowance to ¼ in (6.35 mm). Flip open the triangle formed and press to make Unit 4 which should measure 2 ½ in x 4 ½ in (6.35 cm x 11.43 cm). Repeat to make thirty Unit 4 strips.

Dia. E



9. Refer to Diagram F to sew five Unit 4 strips end to end RST to make the Left Side Border which should measure 2 ½ in x 20 ½ in (6.35 cm x 52.07 cm).

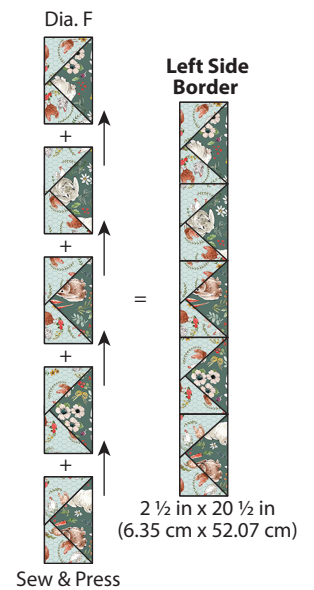

10. Refer to Diagram G to sew five Unit 4 strips end to end RST to make the Right Side Border which should measure 2 ½ in x 20 ½ in (6.35 cm x 52.07 cm).

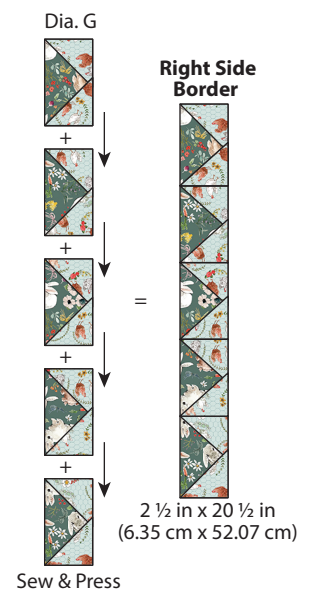

11. Refer to Diagram H to sew ten Unit 4 strips end to end RST. Sew one Chickens on a Wire square 2 ½ in x 2 ½ in (6.35 cm x 6.35 cm) to each end of the newly sewn strip to make the Top Border which should measure 2 ½ in x 44 ½ in (6.35 cm x 113.03 cm).

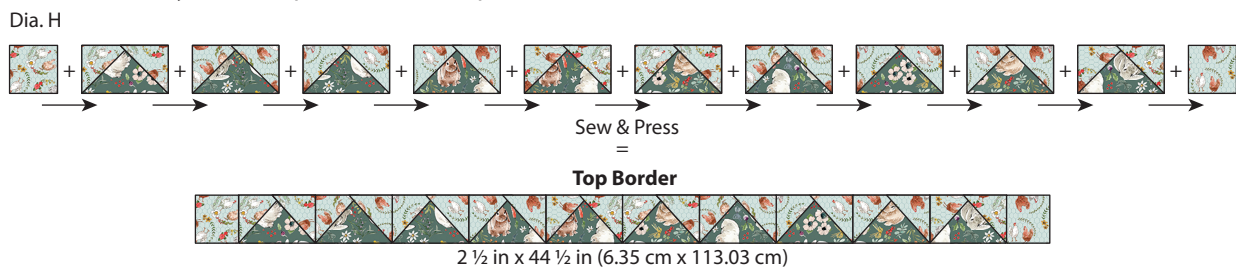

12. Refer to Diagram I to sew ten Unit 4 strips end to end RST. Sew one Chickens on a Wire square 2 ½ in x 2 ½ in (6.35 cm x 6.35 cm) to each end of the newly sewn strip to make the Bottom Border which should measure 2 ½ in x 44 ½ in (6.35 cm x 113.03 cm).

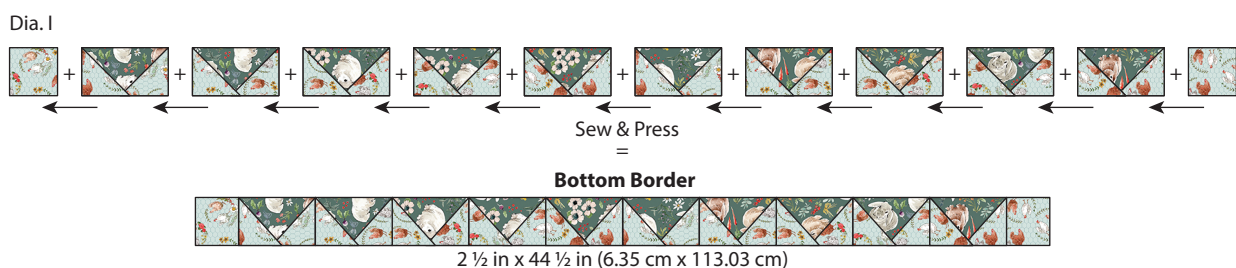

13. Refer to Diagram J to sew one Tossed Flowers strip 1 ½ in x 16 ½ in (3.81 cm x 41.91 cm) RST to each side of the Table Runner Center. Sew one Tossed Flowers strip 1 ½ in x 38 ½ in (3.81 cm x 97.79 cm) RST to the top and bottom of the Table Runner Center.
14. Refer to Diagram J to sew one Off White strip 1 ½ in x 18 ½ in (6.35 cm x 46.99 cm) RST to each side of the Table Runner Center. Sew one Off White strip 1 ½ in x 40 ½ in (3.81 cm x 102.87 cm) RST to the top and bottom of the Table Runner Center.
15. Refer to Diagram J to sew the Left Side Border and Right Side border to the left and right sides of the Table Runner Center. Sew the Top Border and Bottom Border to the top and to the bottom of the Table Runner Center to the Table Runner Top. The completed Table Runner Top should measure 24 ½ in x 44 ½ in (62.25 cm x 113.03 cm).

Dia. J

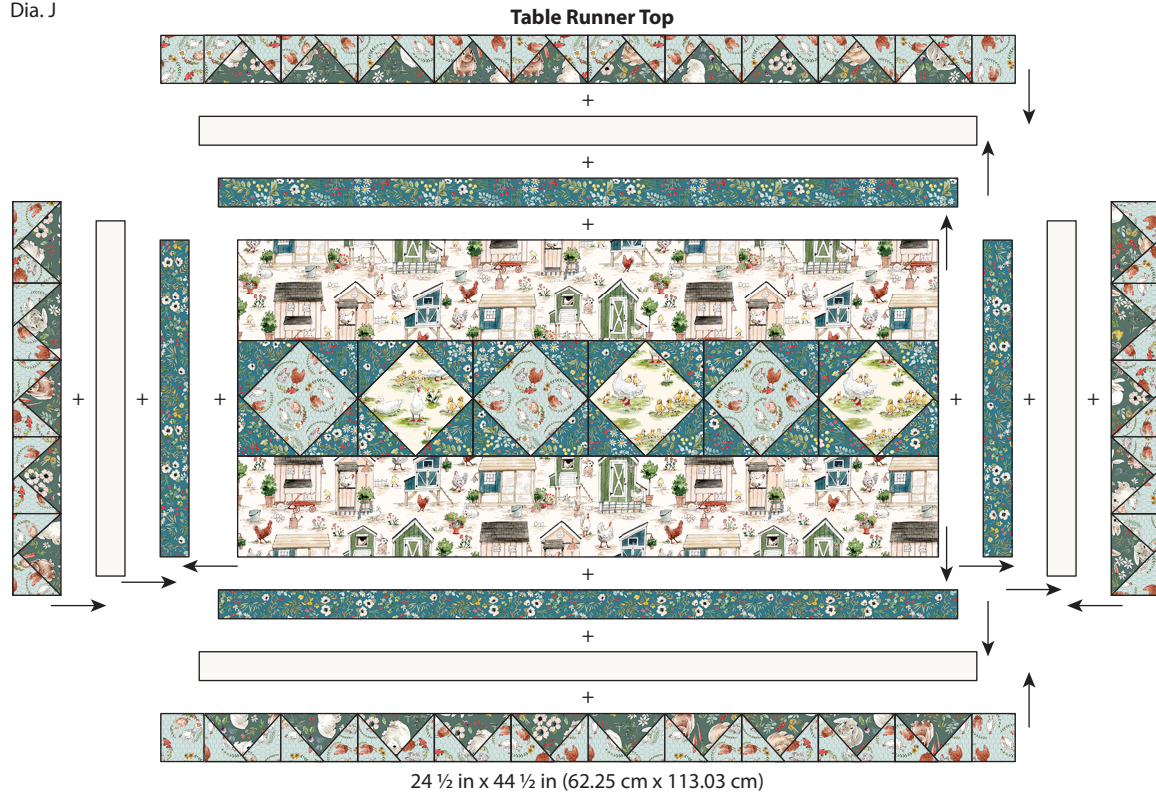

Finishing

16. To make the Chickens on a Wire Backing, remove the selvages from one 32 in x 52 in (81.26 cm x 132.08 cm) as shown in Diagram K.

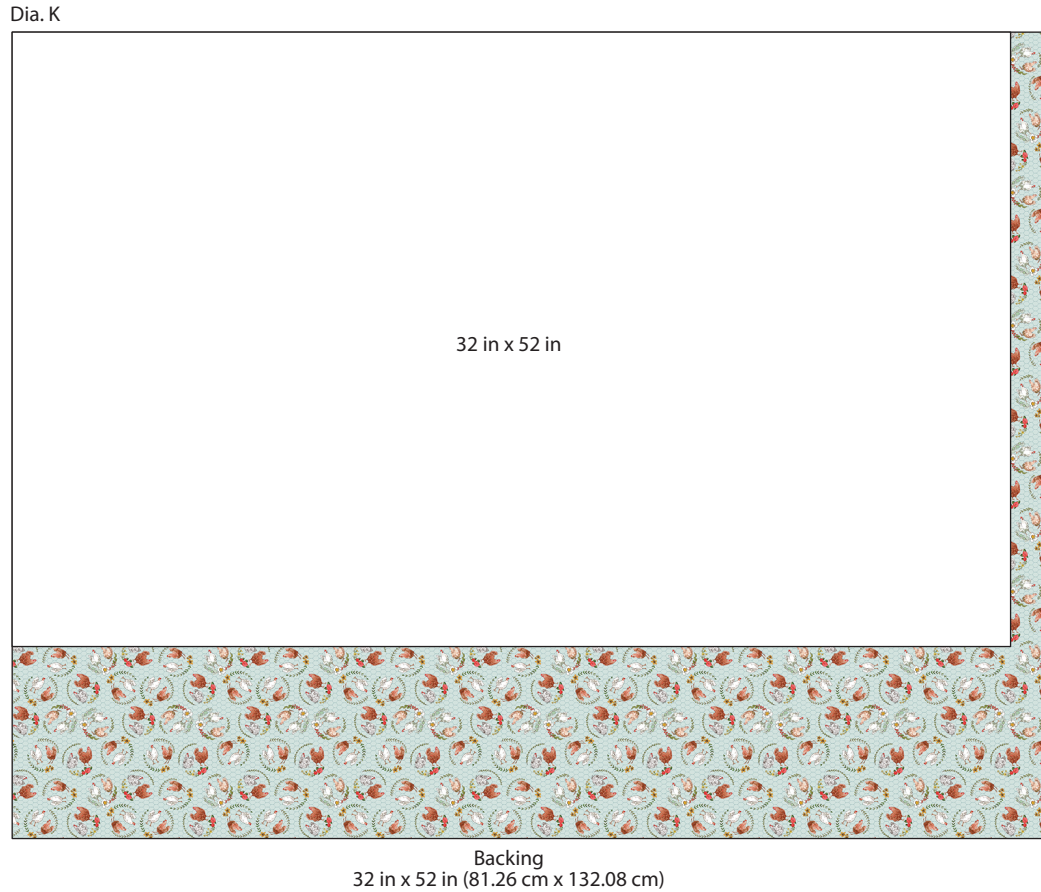

17. Press the finished Table Runner Top and Backing fabric. Tape the Backing wrong side up on a firm surface. Layer Batting and Table Runner Top (right side up). Baste the layers together with safety pins. Quilt as desired.
18. Once the quilting is complete, square up the corners and edges, trimming excess Backing and Batting even with the Table Runner Top.
19. To make the Cottontail Farm Table Runner Binding, remove the selvages and sew the short ends of the Tossed Flowers 2 ½ in x wof (6.35 cm x 106.68 cm) strips RST end to end at a 45 degree angle to make one continuous strip; press seams open. Press one short end ¼ in (6.35 mm) to the **wrong** side. Fold in half lengthwise with **wrong** sides together; press. Leaving a 2 in (5.08 cm) tail on the folded end, place cut edges of folded Binding even with the edge of the Quilt and sew, mitering the corners (Dia. L). Overlap ends, trim any excess and finish sewing the Binding. Fold the Binding over to the back and hand stitch.

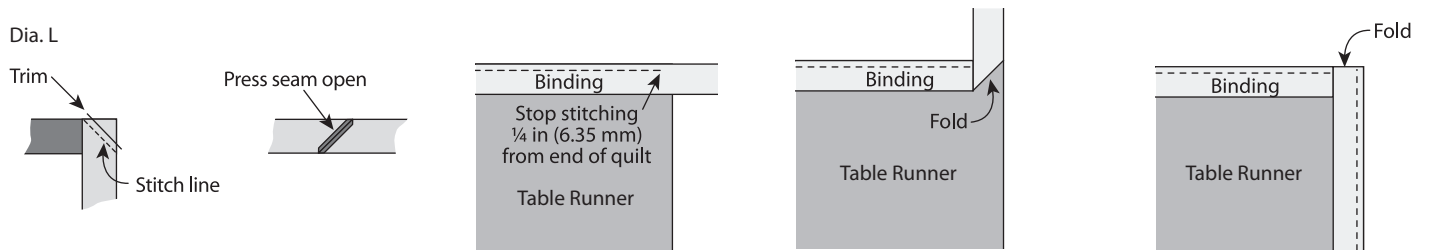

Sewing

Placemats

20. Refer to Diagram M to sew one Tossed Flowers strip $1\frac{1}{2}$ in x $10\frac{1}{2}$ in (3.81 cm x 26.67 cm) RST to each side of one Farm Day square $10\frac{1}{2}$ in x $10\frac{1}{2}$ in (26.67 cm x 26.67 cm). Sew one Tossed Flowers strip $1\frac{1}{2}$ in x $12\frac{1}{2}$ in (3.81 cm x 31.75 cm) RST to the top and bottom of the Farm Day square to make Unit 5 which should measure $12\frac{1}{2}$ in x $12\frac{1}{2}$ in (31.75 cm x 31.75 cm). Repeat to make four Unit 5 squares.

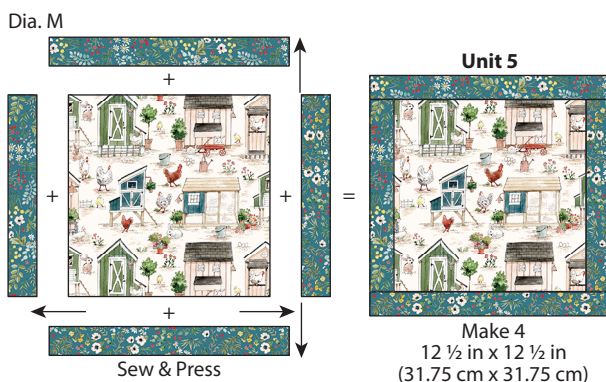

21. Place one Solid Off-White square $2\frac{1}{2}$ in x $2\frac{1}{2}$ in (6.35 cm x 6.35 cm) on the left side of one Chickens on a Wire strip $2\frac{1}{2}$ in x $4\frac{1}{2}$ in (6.35 cm x 11.43 cm) RST. Sew across the diagonal of the square from the upper right corner to the lower left corner as shown in Diagram N. Flip open the triangle formed and press. Trim seam allowance to $\frac{1}{4}$ in (6.35 mm).
22. Place one Solid Off-White square $2\frac{1}{2}$ in x $2\frac{1}{2}$ in (6.35 cm x 6.35 cm) on the right side of one Chickens on a Wire strip RST. Sew across the diagonal of the square from the upper left corner to the lower right corner as shown in Diagram N. Flip open the triangle formed and press. Trim seam allowance to $\frac{1}{4}$ in (6.35 mm) to make Unit 6 which should measure $2\frac{1}{2}$ in x $4\frac{1}{2}$ in (6.35 cm x 11.43 cm). Repeat to make twenty-four Unit 6 strips.

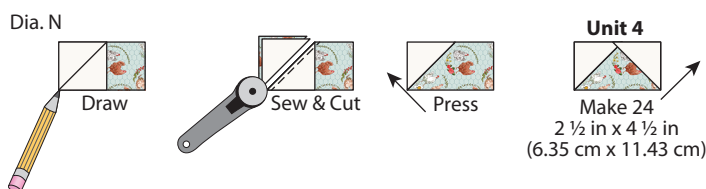

23. Refer to Diagram O to sew three Unit 6 strips end to end RST. Repeat to make a second strip. Sew one newly sewn strip to each side of the Unit 5 square RST to make the Placemat Top. The completed Placemat Top should measure $12\frac{1}{2}$ in x $16\frac{1}{2}$ in (31.75 cm x 41.91 cm).

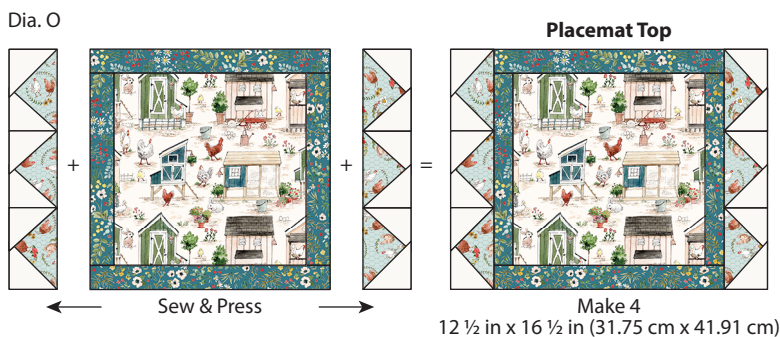

Finishing

24. To make the Tossed Flowers Backing, remove the selvages from four 16 in x 20 in (40.64 cm x 50.8 cm) rectangles as shown in Diagram P.

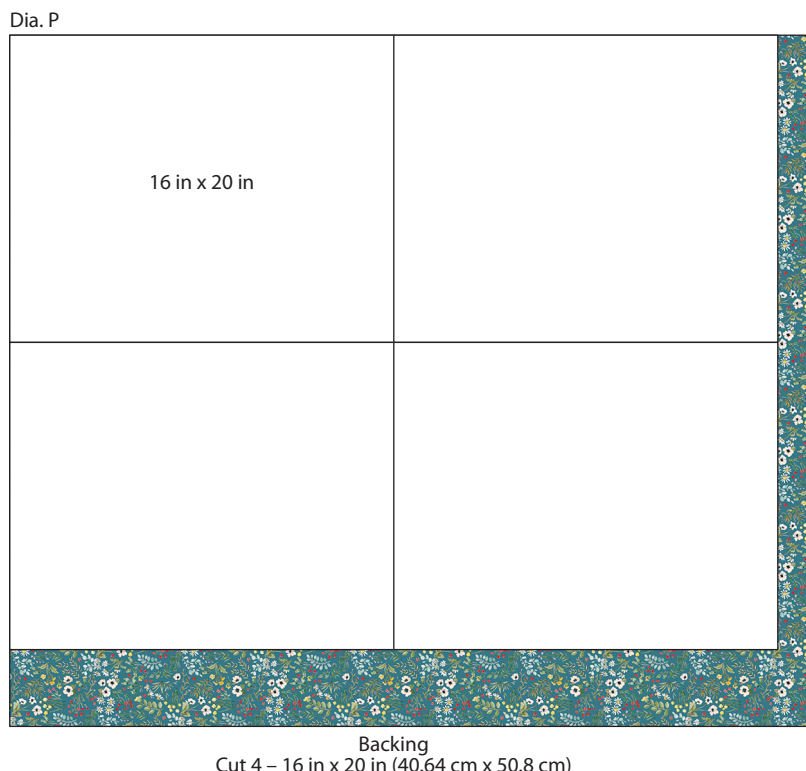

25. Press the finished Placemat Top and Backing fabric. Tape the Backing wrong side up on a firm surface. Layer Batting and Placemat Top (right side up). Baste the layers together with safety pins. Quilt as desired.

26. Once the quilting is complete, square up the corners and edges, trimming excess Backing and Batting even with the Placemat Top.

27. To make the Cottontail Farm Placemat Binding, remove the selvages and sew the short ends of the Tossed Flowers 2 ½ in x wof (6.35 cm x 106.68 cm) strips RST end to end at a 45 degree angle to make one continuous strip; press seams open. Press one short end ¼ in (6.35 mm) to the **wrong** side. Fold in half lengthwise with **wrong** sides together; press. Leaving a 2 in (5.08 cm) tail on the folded end, place cut edges of folded Binding even with the edge of the Quilt and sew, mitering the corners (Dia. Q). Overlap ends, trim any excess and finish sewing the Binding. Fold the Binding over to the back and hand stitch.

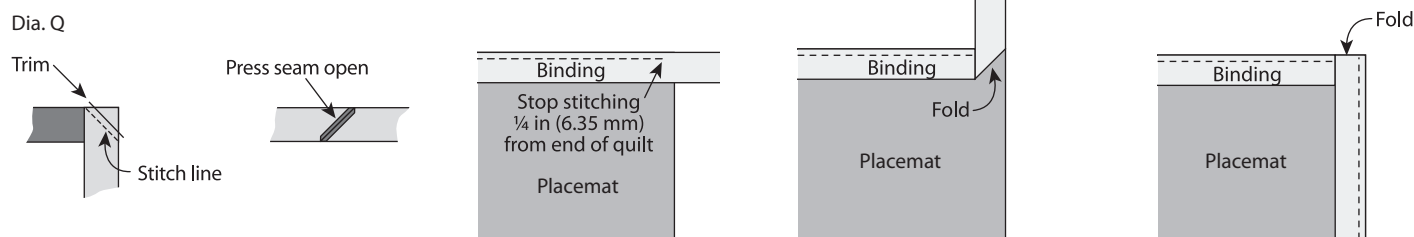

Finished Care Instructions

Machine wash in cold water; gentle cycle. Do not bleach. **Tip:** Before drying, check for fabric dyes that may have run. If fabric dyes run, rewash and rinse using a color catcher to absorb loose dye. Lay flat to dry or tumble dry low.