

# SHOP HOP Quilt



Featuring the  
Shop Hop Collection  
by Beth Albert  
Shipping to stores January 2024

Finished Size: 68 ½ in x 88 ½ in (173.99 cm x 224.79 cm)

## Fabric Needed

### 3 Wishes Fabric® Shop Hop Collection

- 1 yd – Shop Hop Panel (21701-PNL-CTN-D)
- 1 ½ yds – Perfect Squares (21695-MLT-CTN-D) for Piecing and Binding
- 1 ½ yds – Around the Town (21698-GRN-CTN-D)
- 1 ⅛ yds – Tossed Notions (21700-CRM-CTN-D)
- 1 yd – Whirling Windmills (21697-TEA-CTN-D)
- ⅞ yd – Vintage Machines (21696-CRM-CTN-D)
- ⅝ yd – Keepsake Patch (21699-MLT-CTN-D)
- 5 ½ yds – Around the Town (21698-GRN-CTN-D) for Backing

### Additional Supplies Needed:

- 76 in x 96 in (193.04 cm x 243.84 cm) Cotton batting
- Piecing and sewing thread
- Quilting and sewing supplies
- Even-feed foot (optional for quilting)

# Before You Begin

Read all instructions before beginning project. Do not pre-wash fabrics. Press fabrics with a dry iron on cotton setting before cutting. Use a ¼ in (6.35 mm) seam allowance and sew fabrics with right sides together (RST) unless otherwise noted. Press seams in the direction of the arrows. wof = width of fabric

**Note:** A printed panel may become slightly skewed during the finishing process. Check if panel is square before cutting by folding the panel so selvages meet. If all edges do not meet, pull firmly from corner to corner until the edges meet. Continue until all corners are square.

## Cutting

Use a rotary cutter and ruler to cut the size and number of squares and rectangles from each fabric listed below.



**Shop Hop Panel (21701-PNL-CTN-D) – 1 yd (91.44 cm x 106.68 cm)**  
Fussy Cut 4 – 16 ½ in x 16 ½ in (41.91 cm x 41.91 cm)

2 ½ in x wof	
2 ½ in x 20 ½ in	
2 ½ in x 16 ½ in	

**Perfect Squares (21695-MLT-CTN-D) – 1 ½ yds (137.16 cm x 106.68 cm)**  
Cut 8 – 2 ½ in x wof (6.35 cm x 106.68 cm) for Binding  
Cut 12 – 2 ½ in x 20 ½ in (6.35 cm x 52.07 cm)  
Cut 12 – 2 ½ in x 16 ½ in (6.35 cm x 41.91 cm)



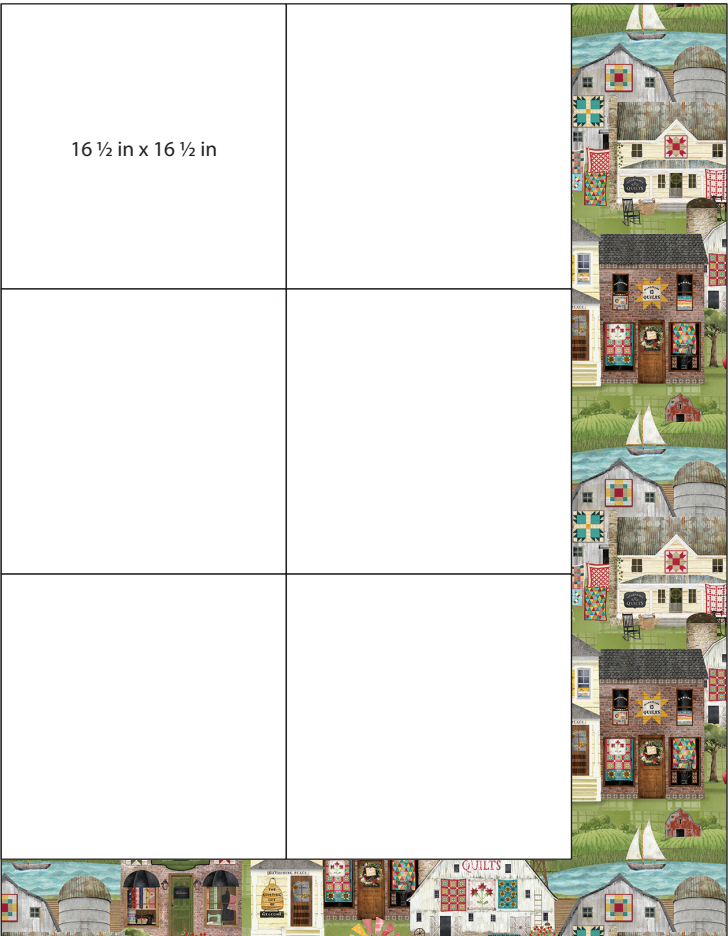

**Around the Town (21698-GRN-CTN-D) – 1 ½ yds (137.16 cm x 106.68 cm)**  
 Cut 6 – 16 ½ in x 16 ½ in (41.91 cm x 41.91 cm)

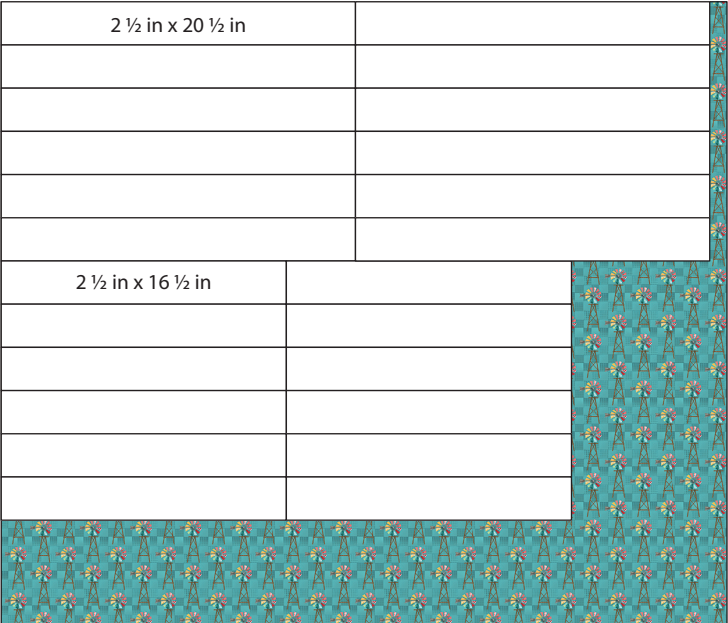

**Whirling Windmills (21697-TEA-CTN-D) – 1 yd (91.44 cm x 106.68 cm)**  
 Cut 12 – 2 ½ in x 20 ½ in (6.35 cm x 52.07 cm)  
 Cut 12 – 2 ½ in x 16 ½ in (6.35 cm x 41.91 cm)



**Tossed Notions (21700-CRM-CTN-D) – 1 ⅞ yds (102.87 cm x 106.68 cm)**  
 Cut 8 – 4 ½ in x 42 in (11.43 cm x 106.68 cm)

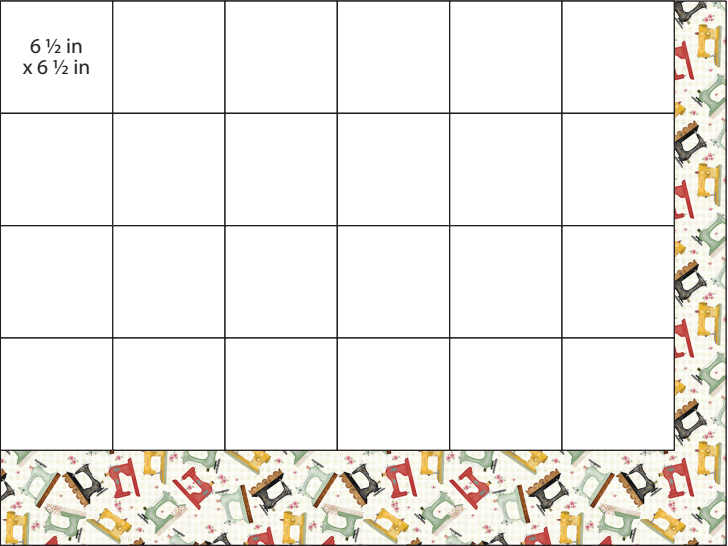

**Vintage Machines (21696-CRM-CTN-D) – 7/8 yd (80.01 cm x 106.68 cm)**  
 Cut 24 – 6 ½ in x 6 ½ in (16.51 cm x 16.51 cm)



**Keepsake Patch (21699-MLT-CTN-D) – 5/8 yd (57.15 cm x 106.68 cm)**  
 Cut 2 – 16 ½ in x 16 ½ in (41.91 cm x 41.91 cm)

# Sewing

1. Refer to Diagram A to sew one Whirling Windmills strip  $2\frac{1}{2}$  in x  $16\frac{1}{2}$  in (6.35 cm x 41.91 cm) RST to each side of one Fussy Cut Shop Hop Panel square  $16\frac{1}{2}$  in x  $16\frac{1}{2}$  in (41.91 cm x 41.91 cm). Sew one Whirling Windmills strip  $2\frac{1}{2}$  in x  $20\frac{1}{2}$  in (6.35 cm x 52.07 cm) RST to the top and bottom of the Fussy Cut Shop Hop Panel square to make Block One which should measure  $20\frac{1}{2}$  in x  $20\frac{1}{2}$  in (52.07 cm x 52.07 cm). Repeat to make a second Block One.



2. Refer to Diagram B to sew one Perfect Squares strip  $2\frac{1}{2}$  in x  $16\frac{1}{2}$  in (6.35 cm x 41.91 cm) RST to each side of one Fussy Cut Shop Hop Panel square  $16\frac{1}{2}$  in x  $16\frac{1}{2}$  in (41.91 cm x 41.91 cm). Sew one Perfect Squares strip  $2\frac{1}{2}$  in x  $20\frac{1}{2}$  in (6.35 cm x 52.07 cm) RST to the top and bottom of the Fussy Cut Shop Hop Panel square to make Block Two which should measure  $20\frac{1}{2}$  in x  $20\frac{1}{2}$  in (52.07 cm x 52.07 cm). Repeat to make a second Block Two.

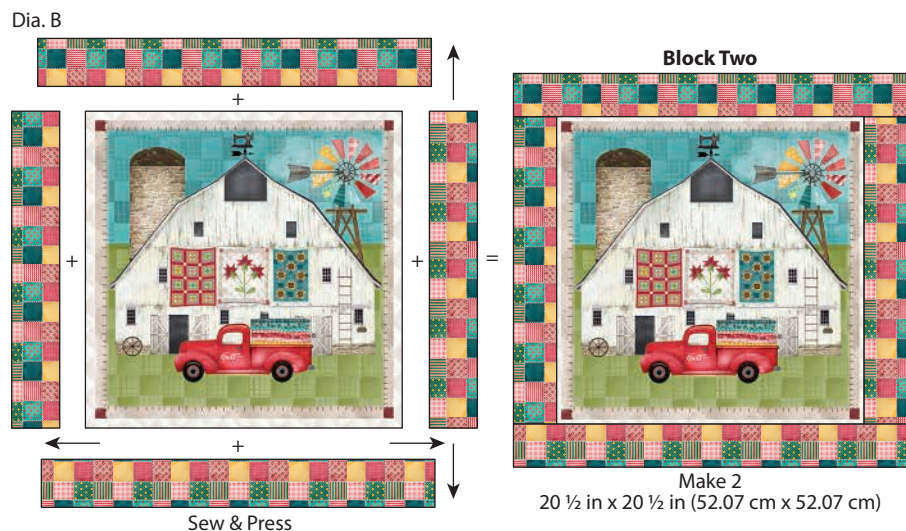

3. Refer to Diagram C to sew one Whirling Windmills strip  $2\frac{1}{2}$  in x  $16\frac{1}{2}$  in (6.35 cm x 41.91 cm) RST to each side of one Keepsake Patch square  $16\frac{1}{2}$  in x  $16\frac{1}{2}$  in (41.91 cm x 41.91 cm). Sew one Whirling Windmills strip  $2\frac{1}{2}$  in x  $20\frac{1}{2}$  in (6.35 cm x 41.91 cm) RST to the top and bottom of the Keepsake Patch square to make Block Three which should measure  $20\frac{1}{2}$  in x  $20\frac{1}{2}$  in (41.91 cm x 41.91 cm).

Dia. C





4. Refer to Diagram D to sew one Perfect Squares strip  $2\frac{1}{2}$  in x  $16\frac{1}{2}$  in (6.35 cm x 41.91 cm) RST to each side of one Keepsake Patch square  $16\frac{1}{2}$  in x  $16\frac{1}{2}$  in (41.91 cm x 41.91 cm). Sew one Perfect Squares strip  $2\frac{1}{2}$  in x  $20\frac{1}{2}$  in (6.35 cm x 41.91 cm) RST to the top and bottom of the Keepsake Patch square to make Block Four which should measure  $20\frac{1}{2}$  in x  $20\frac{1}{2}$  in (41.91 cm x 41.91 cm).

Dia. D



5. Place one Vintage Machines square  $6\frac{1}{2}$  in x  $6\frac{1}{2}$  in (16.51 cm x 16.51 cm) on the top left corner of one Around the Town square  $16\frac{1}{2}$  in x  $16\frac{1}{2}$  in (41.91 cm x 41.91 cm) as shown in Diagram E. Pin RST, sew across the diagonal of the Vintage Machines square from the upper right corner to the lower left corner. Flip open the triangle formed and press. Trim away the excess fabric from behind the triangle  $\frac{1}{4}$  in (6.35 mm) away from the sewn seam. Repeat with the remaining three Vintage Machines squares in the other corners of the Around the Town square to make Unit 1 which should measure  $16\frac{1}{2}$  in x  $16\frac{1}{2}$  in (41.91 cm x 41.91 cm). Repeat to make six Unit 1 squares.

Dia. E



Draw



Sew & Cut



Press

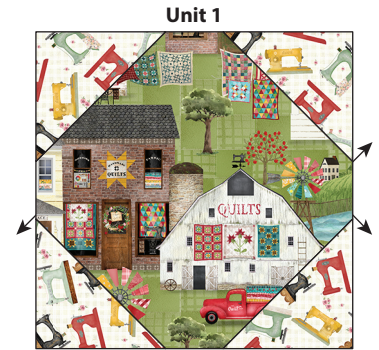

**Unit 1**

Make 6  
 $16\frac{1}{2}$  in x  $16\frac{1}{2}$  in (41.91 cm x 41.91 cm)

6. Refer to Diagram F to sew one Perfect Squares strip  $2\frac{1}{2}$  in x  $16\frac{1}{2}$  in (6.35 cm x 16.51 cm) RST to each side of one Unit 1. Sew one Perfect Squares strip  $2\frac{1}{2}$  in x  $20\frac{1}{2}$  in (6.35 cm x 52.07 cm) RST to the top and bottom of the Unit 1 to make Block Five which should measure  $20\frac{1}{2}$  in x  $20\frac{1}{2}$  in (52.07 cm x 52.07 cm). Repeat to make three Block Five squares.

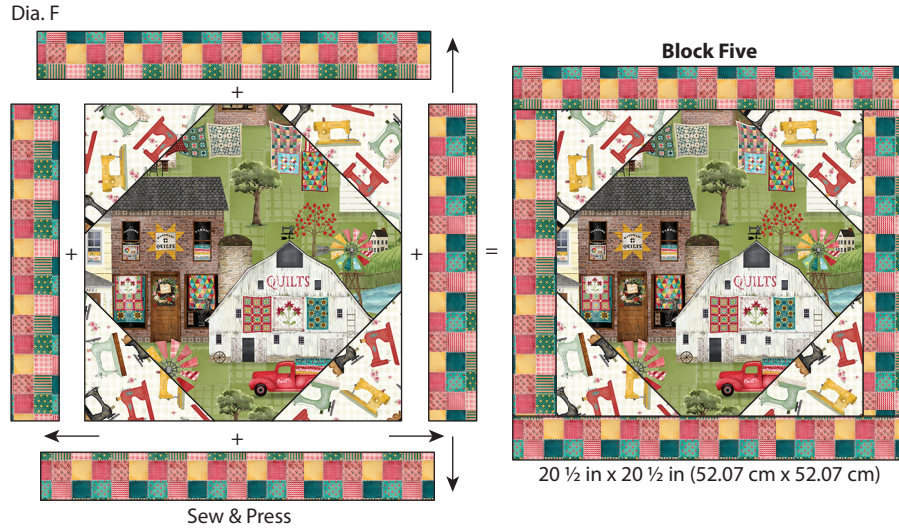

7. Refer to Diagram G to sew one Whirling Windmills strip  $2\frac{1}{2}$  in x  $16\frac{1}{2}$  in (6.35 cm x 16.51 cm) RST to each side of one Unit 1. Sew one Whirling Windmills strip  $2\frac{1}{2}$  in x  $20\frac{1}{2}$  in (6.35 cm x 52.07 cm) RST to the top and bottom of the Unit 1 to make Block Six which should measure  $20\frac{1}{2}$  in x  $20\frac{1}{2}$  in (52.07 cm x 52.07 cm). Repeat to make three Block Six squares.

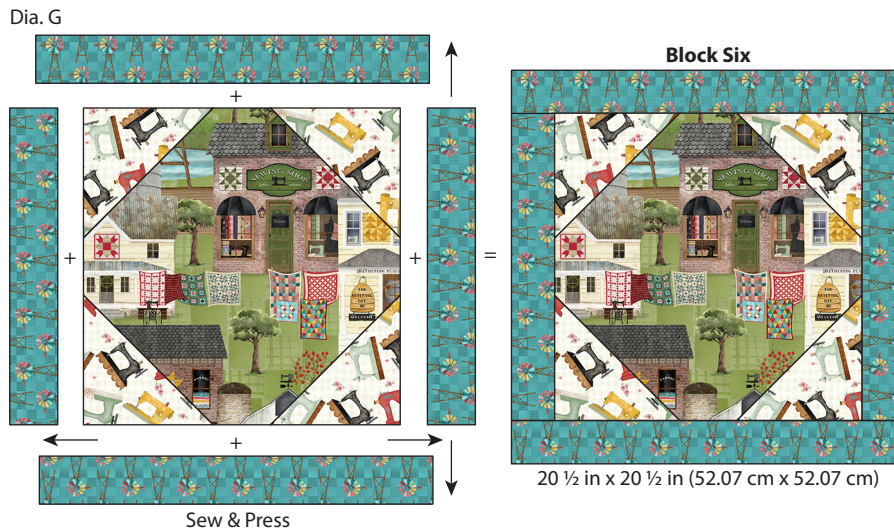



8. Refer to Diagram H to sew one Block One to each side of one Block Five RST to make Row One. Sew one Block Five to each side of one Block Three RST to make Row Two. Sew one Block Six to each side of one Block Four RST to make Row Three. Sew one Block Two to each side of one Block Six RST to make Row Four.
9. Refer to Diagram H to sew Row One, Row Two, Row Three and Row Four RST to make the Quilt Center. The Quilt Center should measure 60 ½ in x 80 ½ in (153.67 cm x 204.47 cm).

Dia. H

Quilt Center

Row One



+

Row Two



+

Row Three



+

Row Four

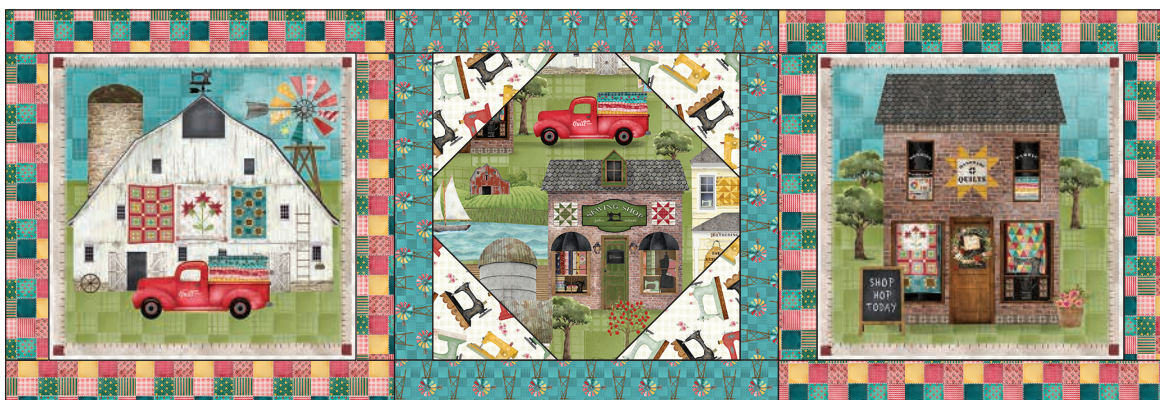

60 ½ in x 80 ½ in (153.67 cm x 204.47 cm)



10. Sew four Tossed Notions strips  $4\frac{1}{2}$  in x 42 in (11.43 cm x 106.68 cm) end to end RST with diagonal seams; trim seam allowance to  $\frac{1}{4}$  in (6.35 mm). From the sewn strip, cut two Tossed Notions strips  $4\frac{1}{2}$  in x  $80\frac{1}{2}$  in (11.43 cm x 204.47 cm). Refer to Diagram I to sew one Tossed Notions strip  $4\frac{1}{2}$  in x  $80\frac{1}{2}$  in (11.43 cm x 204.47 cm) RST to each side of the Quilt Center.
11. Sew four Tossed Notions strips  $4\frac{1}{2}$  in x 42 in (11.43 cm x 106.68 cm) end to end RST with diagonal seams; trim seam allowance to  $\frac{1}{4}$  in (6.35 mm). From the sewn strip, cut two Tossed Notions strips  $4\frac{1}{2}$  in x  $68\frac{1}{2}$  in (11.43 cm x 173.99 cm). Refer to Diagram I to sew one Tossed Notions strip  $4\frac{1}{2}$  in x  $68\frac{1}{2}$  in (11.43 cm x 173.99 cm) RST to the top and bottom of the Quilt Center to make the Quilt Top. The completed Quilt Top should measure  $68\frac{1}{2}$  in x  $88\frac{1}{2}$  in (173.99 cm x 224.84 cm).

Dia. I

Quilt Top



$68\frac{1}{2}$  in x  $88\frac{1}{2}$  in (173.99 cm x 224.79 cm)



# Finishing

11. To make the Around the Town Backing, remove the selvages and cut two pieces 42 in x 89 in (106.68 cm x 226.06 cm).

**Note:** Check orientation of the designs. Pin and sew the pieces RST along the long edges as shown in Diagram J. Trim the Back to measure 76 in x 96 in (193.04 cm x 243.84 cm).

Dia. J



Backing  
76 in x 96 in (193.04 cm x 243.84 cm)

12. Press the finished Quilt Top and Backing fabric. Tape the Backing **wrong** side up on a firm surface. Layer Batting and Quilt Top (right side up). Baste the layers together with safety pins. Quilt as desired.

13. Once the quilting is complete, square up the corners and edges, trimming excess Backing and Batting even with the Quilt Top.

19. To make the Shop Hop Binding, remove the selvages and sew the short ends of the Perfect Squares 2 ½ in x wof (6.35 cm x 106.68 cm) strips RST end to end at a 45 degree angle to make one continuous strip; press seams open. Press one short end ¼ in (6.35 mm) to the **wrong** side. Fold in half lengthwise with **wrong** sides together; press. Leaving a 2 in (5.08 cm) tail on the folded end, place cut edges of folded Binding even with the edge of the Quilt and sew, mitering the corners (Dia. K). Overlap ends, trim any excess and finish sewing the Binding. Fold the Binding over to the back and hand stitch.

Dia. K

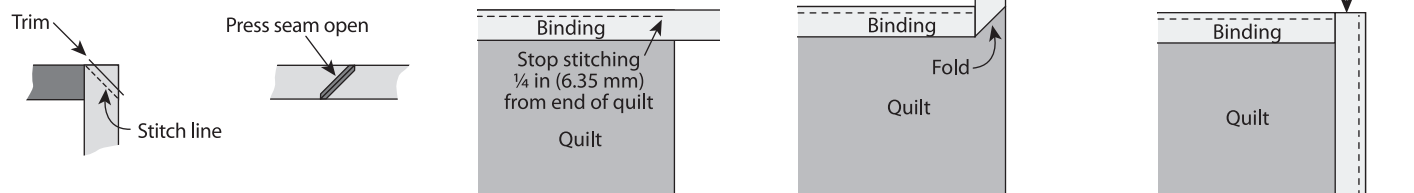

## Finished Care Instructions

Machine wash in cold water; gentle cycle. Do not bleach. **Tip:** Before drying, check for fabric dyes that may have run. If fabric dyes run, rewash and rinse using a color catcher to absorb loose dye. Lay flat to dry or tumble dry low.