

Winter Memories

Strip Quilt



Featuring fabrics from the **Winter Memories** collection by **Whimsies and Wishes** for **STUDIO·e·fabrics**

Fabric Requirements

(A) 2994M-11	½ yard	(I) 2998-99	¼ yard
(B) 2998-11	½ yard	(J) 2996M-99	¼ yard
(C) Charcoal-14**....	½ yard	(K) 2997-99	¼ yard
(D) 2995M-11	½ yard	(L) 2993M-99	1 ½ yards
(E) 2996M-11	¼ yard	(M) Carbon-23*	⅔ yard*
(F) 2993M-11	1 ½ yards	Backing	
(G) Oyster-35**.....	¼ yard	2997-11	3 yards
(H) 2994M-99	¼ yard		

Additional Supplies Needed

Batting 51" x 58"
 Piecing and sewing thread
 Quilting and sewing supplies
 Quilt designed by Heidi Pridemore
 Finished Quilt Size 43" x 50"
 * Includes Binding
 ** Peppered Cotton

Cutting

Cutting Instructions

Please note: all strips are cut across the width of fabric (WOF) from selvage to selvage edge.

WOF= Width of Fabric • LOF = Length of Fabric

Fabric A (2994M-11 Poinsettia – Lt. Gray), cut:

- (1) 5 $\frac{7}{8}$ " x WOF strip, sub-cut (6) 5 $\frac{7}{8}$ " squares. Cut squares across one diagonal to make (12) triangles.
- (1) 6 $\frac{1}{4}$ " x WOF strip, sub-cut (3) 6 $\frac{1}{4}$ " squares. Cut squares across both diagonals to make (12) triangles.

Fabric B (2998-11 Mini Stripe – Lt. Gray), cut:

- (1) 6 $\frac{1}{4}$ " x WOF strip, sub-cut (6) 6 $\frac{1}{4}$ " squares. Cut squares across both diagonals to make (24) triangles. (The two triangles from the sides are not used.)
- (1) 5 $\frac{7}{8}$ " x WOF strip, sub-cut (4) 5 $\frac{7}{8}$ " squares. Cut squares across one diagonal to make (8) triangles.

Fabric C (Charcoal-14 Peppered Cotton – Charcoal), cut:

- (2) 6 $\frac{1}{4}$ " x WOF strips, sub-cut (10) 6 $\frac{1}{4}$ " squares. Cut squares across both diagonals to make (40) triangles.

Fabric D (2995M-11 Medallion – Lt. Gray), cut:

- (1) 6 $\frac{1}{4}$ " x WOF strip, sub-cut (2) 6 $\frac{1}{4}$ " squares. Cut squares across both diagonals to make (8) triangles.
- (1) 5 $\frac{7}{8}$ " x WOF strip, sub-cut (6) 5 $\frac{7}{8}$ " squares. Cut squares across one diagonal to make (12) triangles.

Fabric E (2996M-11 Reindeer – Lt. Gray), cut:

- (1) 6 $\frac{1}{4}$ " x WOF strip, sub-cut (2) 6 $\frac{1}{4}$ " squares and (4) 5 $\frac{7}{8}$ " squares. Cut the 5 $\frac{7}{8}$ " squares across one diagonal to get (8) triangles and the 6 $\frac{1}{4}$ " squares across both diagonals to make (8) triangles.

Fabric F (2993M-11 Large Stripe – Lt. Gray), cut:

- (3) 3" x WOF strips. Sew strips together, end to end with diagonal seams, and cut (2) 3" x 50 $\frac{1}{2}$ " strips.

Fabric G (Oyster-35 Peppered Cotton – Oyster), cut:

- (1) 6 $\frac{1}{4}$ " x WOF strip, sub-cut (5) 6 $\frac{1}{4}$ " squares. Cut squares across both diagonals to make (20) triangles.

Fabric H (2994M-99 Poinsettia – Black), cut:

- (1) 6 $\frac{1}{4}$ " x WOF strip, sub-cut (1) 6 $\frac{1}{4}$ " squares (3) 5 $\frac{7}{8}$ " squares. Cut the 5 $\frac{7}{8}$ " squares across (1) diagonal to get (6) triangles and the 6 $\frac{1}{4}$ " square across both diagonals to make (4) triangles.

Fabric I (2998-99 Mini Stripe – Black), cut:

- (1) 6 $\frac{1}{4}$ " x WOF strip, sub-cut (2) 6 $\frac{1}{4}$ " squares (3) 5 $\frac{7}{8}$ " squares. Cut the 5 $\frac{7}{8}$ " squares across (1) diagonal to get (6) triangles and the 6 $\frac{1}{4}$ " squares across both diagonals to make (8) triangles.

Fabric J (2996M-99 Reindeer – Black), cut:

- (1) 6 $\frac{1}{4}$ " x WOF strip, sub-cut (2) 6 $\frac{1}{4}$ " squares (2) 5 $\frac{7}{8}$ " squares. Cut the 5 $\frac{7}{8}$ " squares across (1) diagonal to get (4) triangles and the 6 $\frac{1}{4}$ " squares across both diagonals to make (8) triangles.

Fabric K (2997-99 Snowflakes – Black), cut:

- (1) 6 $\frac{1}{4}$ " x WOF strip, sub-cut (1) 6 $\frac{1}{4}$ " squares (2) 5 $\frac{7}{8}$ " squares. Cut the 5 $\frac{7}{8}$ " squares across (1) diagonal to get (4) triangles and the 6 $\frac{1}{4}$ " square across both diagonals to make (4) triangles.

Fabric L (2993M-99 Large Stripe – Black), cut:

- (3) 3" x WOF strips. Sew strips together, end to end with diagonal seams, and cut (2) 3" x 50 $\frac{1}{2}$ " strips.

Fabric M (Carbon-23 Peppered Cotton – Carbon), cut:

- (9) 1" x WOF strips. Sew strips together, end to end with diagonal seams, and cut (6) 1" x 50 $\frac{1}{2}$ " strips.
- (5) 2 $\frac{1}{2}$ " x WOF strips for the binding.

Backing (2997-11 Snowflake – Lt. Gray), cut:

- (2) 51" x WOF strips. Sew the strips together and trim to 51" x 58" piece for the back.

Sewing

Sew using a ¼" seam allowance with right sides together (RST) unless otherwise indicated. Always press towards the darker fabric while assembling, unless otherwise noted by the arrows.

Block Assembly

1. Sew (1) 5 7/8" Fabric A triangle, (1) 6 ¼" Fabric B triangle and (1) Fabric C triangle together to make (1) ABC block (Fig. 1). Repeat to make (6) ABC blocks total. Sew (1) 5 7/8" Fabric A triangle, (1) Fabric B 6 ¼" triangle and (1) Fabric C triangle together to make (1) mirror image ABC block (Fig. 2). Repeat to make (6) mirror image ABC blocks total.



2. Refer to Figure 3, repeat Step 1 and use the chart below to make the designated number of blocks. The total number of blocks include the regular block and the mirror block.

5 7/8" triangle	6 ¼" side triangle	6 ¼" triangle	# of blocks
(12) Fabric D	(12) Fabric C	(12) Fabric A	(12) DAC
(8) Fabric E	(8) Fabric C	(8) Fabric D	(8) EDC
(8) Fabric B	(8) Fabric C	(8) Fabric E	(8) BEC
(6) Fabric H	(6) Fabric G	(6) Fabric I	(6) HIG
(6) Fabric I	(6) Fabric G	(6) Fabric J	(6) IJG
(4) Fabric J	(4) Fabric G	(4) Fabric K	(4) JKG
(4) Fabric K	(4) Fabric G	(4) Fabric H	(4) KHG

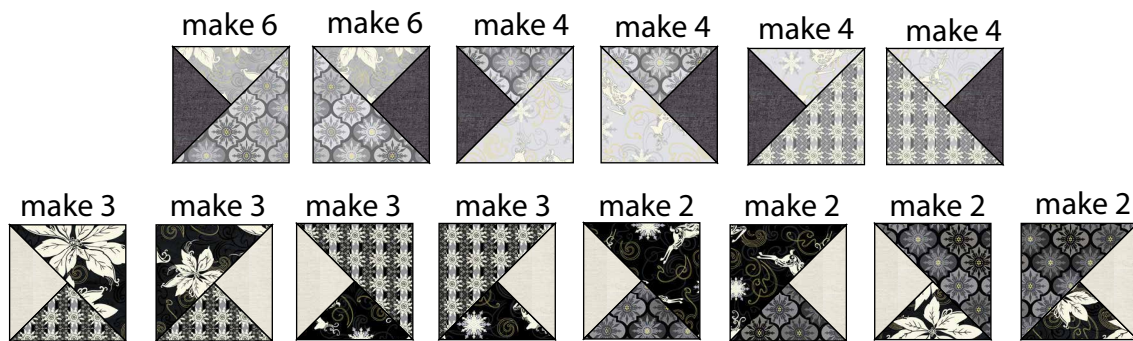

Fig. 3

3. Sew the (1) regular ABC block and the (1) mirror image ABC block together to make (1) ABC rectangle (Fig. 4). Repeat to make (6) ABC rectangles.



Fig. 4

4. Refer to Figure 5 and repeat Step 3 for all remaining blocks.

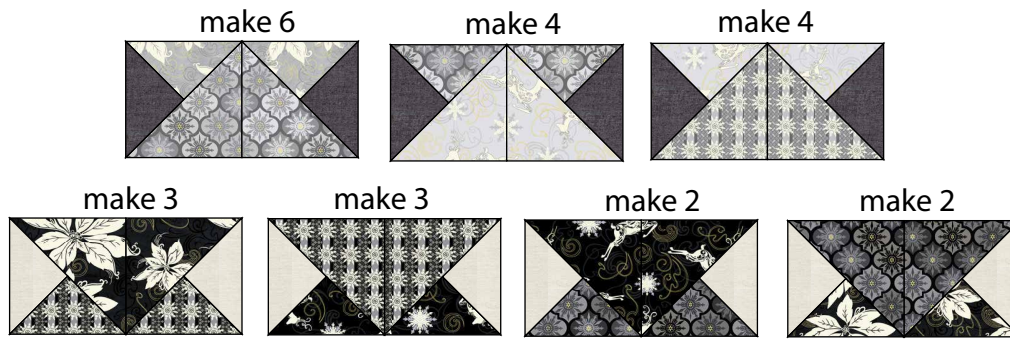

Fig. 5

Quilt Top Assembly

5. Sew the following rectangles together, lengthwise, in the order listed, to make Column One: ABC, DAC, EDC, BEC, ABC, DAC, EDC, BEC, ABC and DAC (Fig. 6). Repeat to make Column Three.

6. Repeat Step 5 using HIG, IJG, JKG, KHG, HIG, IJG, JKG, KHG, HIG and IJG to make Column Two (Fig. 7).

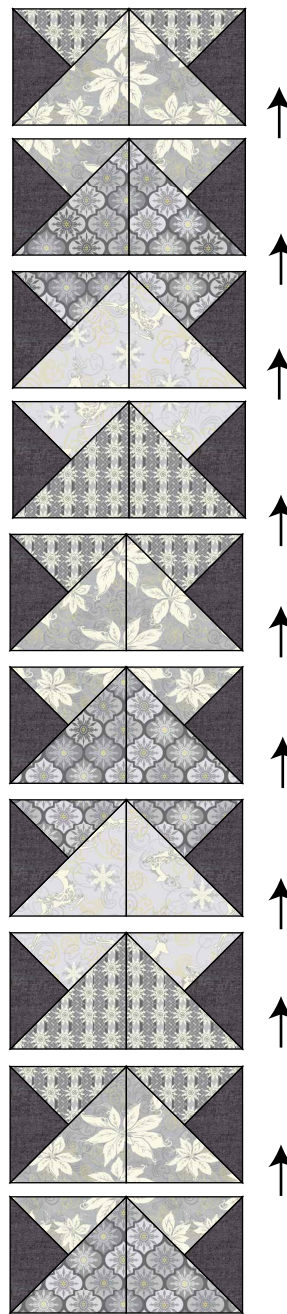

Fig. 6 make 2

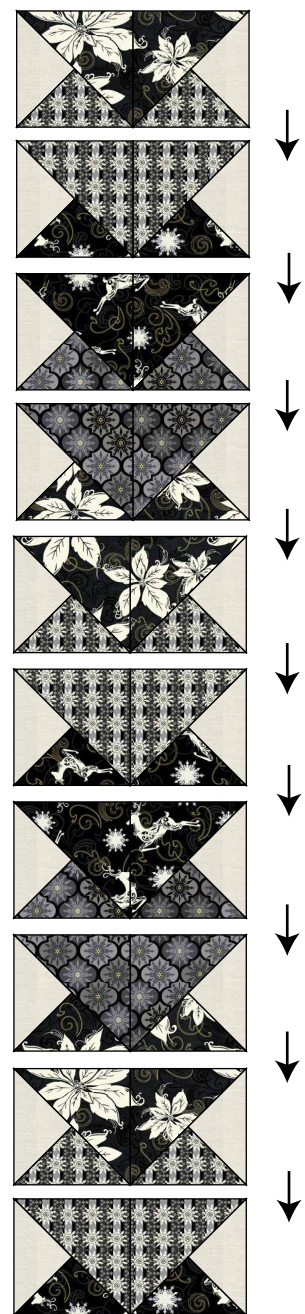

Fig. 7

7. Sew (2) 3" x 50 1/2" Fabric F strips, (6) 1" x 50 1/2" Fabric M strips, the three columns, and (2) 3" x 50 1/2" Fabric L strips together to make the quilt top (Fig. 8).

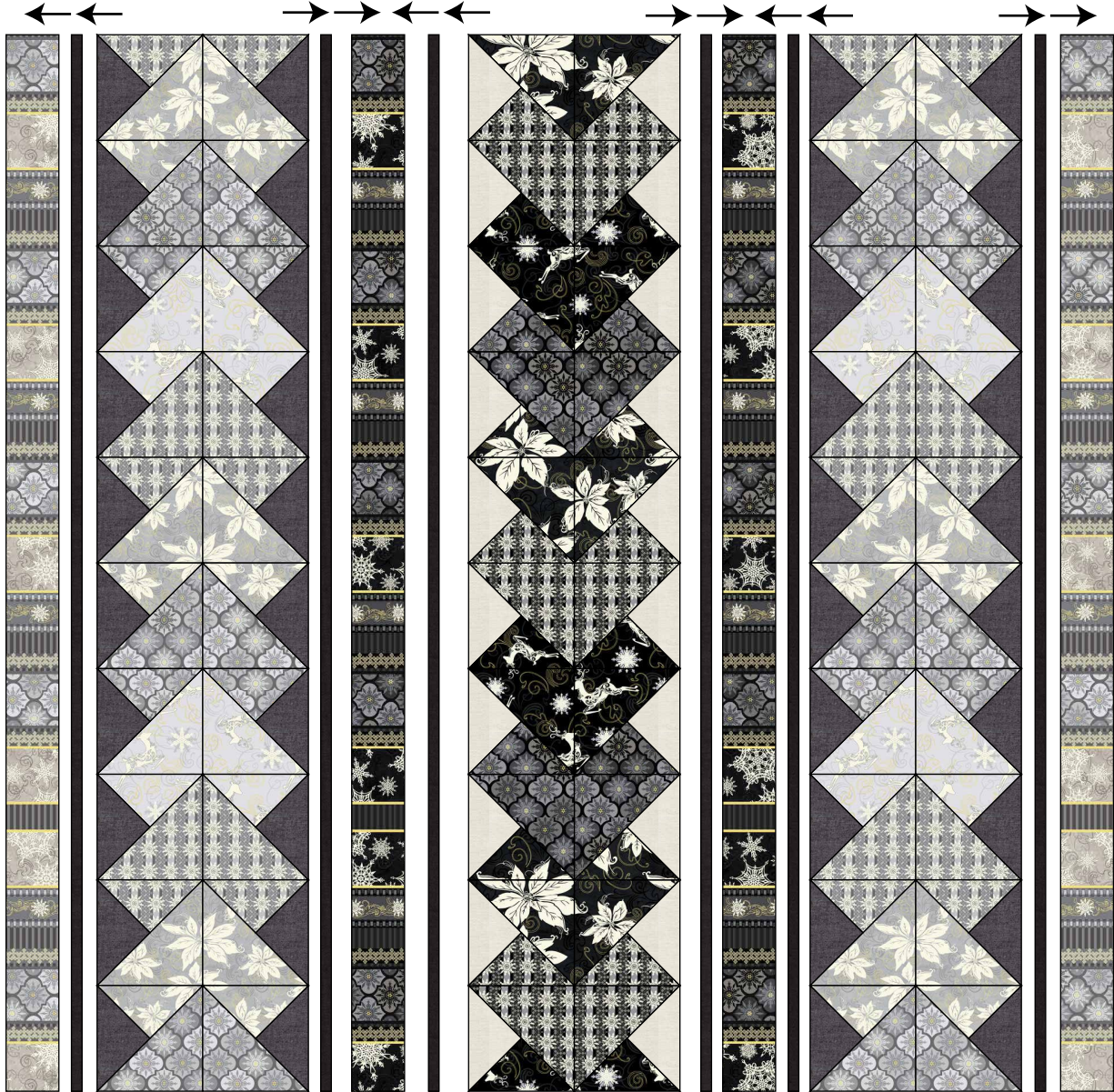

Fig. 8

Layering, Quilting and Finishing

8. Press the quilt top and 51" x 58" backing well. Layer backing (wrong side up), batting, pressed quilt top (right side up) and baste. Quilt as desired and trim excess batting and backing when quilting is complete.

Binding

9. Cut the ends of the (5) Fabric M binding strips at a 45-degree angle and sew end to end to make (1) continuous piece of binding. Fold in half lengthwise and press wrong sides together.

10. Sew the binding to the front of the quilt, raw edges together. Turn the folded edge to the back, and hand stitch in place.